

El method is not charged 20 suction installation instructions



1. Remove the original car poles and lower left leg, install our bottom bracket (ball head toward the car), with the original screw fixation



2. In the original car left bracket installation we poles (with the poles on line up), remove the original car stopper, lines to poles go down from above



3. Remove the original car poles and right bracket, installation we lower bracket (ball head toward the car), with the original screw fixation



4. In the original car right bracket installation we poles (with the poles on line up), remove the original car stopper, lines to poles go down from above



5. Remove the plaque, door trim lines to hall go to end



6. On the right side of the main drive below, unplug the original 20 a fuse, connect our power plug

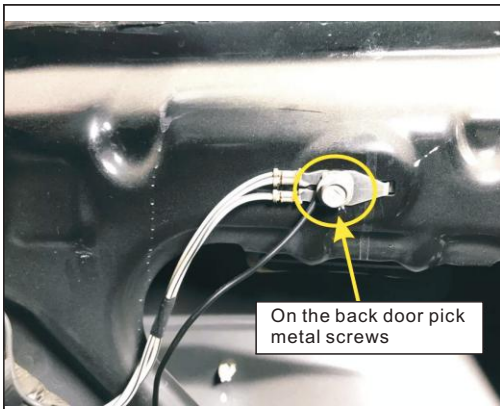

On the back door pick metal screws

7. Back door pick our power supply ground wire



8. Main driving position according to the figure to find corresponding, special switch will spare parts for replacement



Our yellow Central Line meet the seat white line

9. Right below the main driving remove the plaque, find the Central Line, our yellow Central Line after the seat white line



10. Pull off the back door to transfer before we switch socket socket



11. Remove the original car door lock on our electric suction installation, use the original car screws

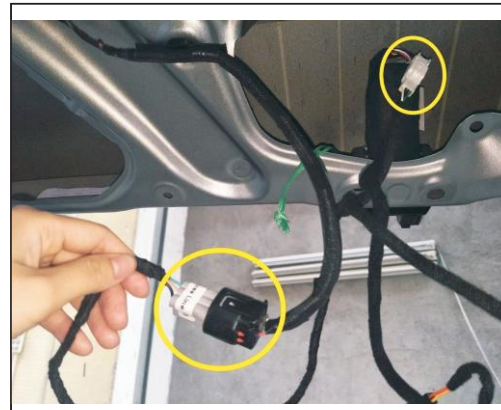

12. Pull off the back door to plug socket tee adaptor, the wire and tee socket with electric suction lock to plug from the socket



13. Installation position and control box, according to the color, shape will be socket head on the corresponding socket (pay attention to check whether the plug tight)



14. Stern door key installation location